

# KEYED FOOTING

VERSACORE  
WALL PANEL  
BY FABCON

SHIM AS  
REQUIRED  
& GROUT  
BY FABCON

INSIDE EDGE  
OF KEY  
MUST  
BE STRAIGHT  
AND TRUE FOR  
ALIGNMENT OF  
WALL PANELS

TOP OF FTG.  
ELEVATION  
TAKEN HERE

3"  
KEYWAY

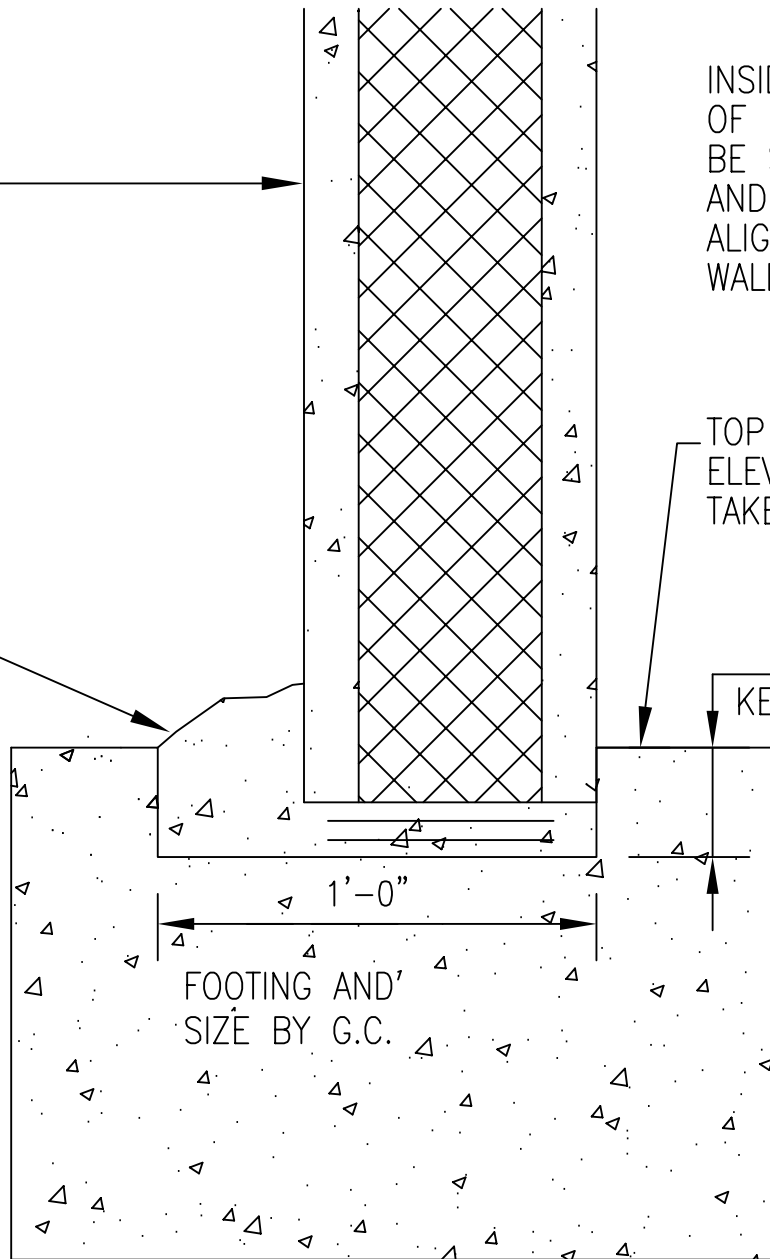

FOOTING AND  
SIZE BY G.C.

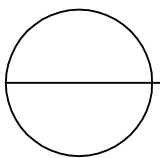

DETAIL

1 1/2" = 1'-0"